

MiniSWASH I

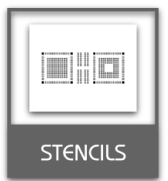

STENCILS

MiniSWASH II

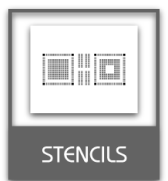

STENCILS

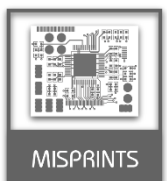

MISPRINTS

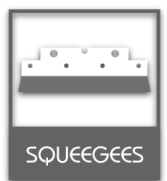

SQUEEGEES

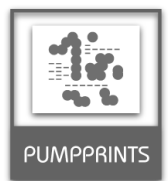

PUMPPRINTS

MiniSWASH III

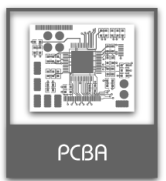

PCBA

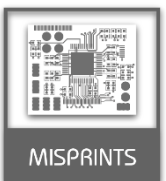

MISPRINTS



Machine types

MiniSWASH I	Wash + Dry
MiniSWASH II	Wash (Heat to 60 °C) + Rinse (Tap water or DI water) + Dry
MiniSWASH III	Wash (Heat to 60 °C) + Double Rinse (2x 25 L Carbon, 25 L Mixbed) + Dry

Technological data

Machine type	I	II open loop	II closed loop	III
Number of cleaning phases	2	3	3	3
Washing, heating	max 60 °C	max 60 °C	max 60 °C	max 60 °C
Rinsing	-	tap water	DI water	DI water
Drying	max 90 °C	max 90 °C	max 90 °C	max 90 °C
Mechanical filtration (Washing)	20" 5 µm	20" 5 µm	20" 5 µm	20" 5 µm
Mechanical filtration (Rinsing)	-	10" 5 µm	10" 1 µm 10" 5 µm	(10" 5 µm) 10" 1 µm
Chemical filtration (Rinsing)	-	-	Active carbon Mixbed	2x Active carbon 2x Mixbed
Wash tank volume max/min	62/34 l	62/34 l	62/34 l	62/34 l
Rinse tank volume max/min	-	32.5/22 l	39/22 l	39/22 l
Pressure on the nozzles with new filters (Washing)	2.7 bar	2.7 bar	2.7 bar	2.7 bar
Flow with new filters (Washing)	~ 50 l/min	~ 50 l/min	~ 50 l/min	~ 50 l/min
Pressure on the nozzles with new filters (Rinsing)	-	2.6 bar	1.8 bar	1.8 bar
Flow with new filters (Rinsing)	-	~ 48 l/min	~ 40 l/min	~ 40 l/min
Speed of rotary arms (motor drive)	12-15 n/min			
Number of installed nozzles	52 (= 22+4+21+4)			

Note: Approximate values of pressure and flow are stated. The real values can be a bit different depending on the tolerances of used components. These differences have no effect on cleaning process.

Usable space

Usable space between the nozzles is 60 mm (30 mm from axis to one and to second side)

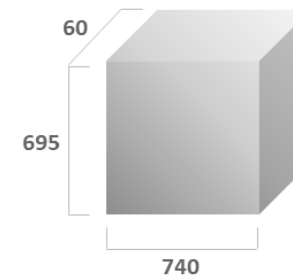

Technical parameters

	MiniSWASH I	MiniSWASH II open loop	MiniSWASH II closed loop	MiniSWASH III
Dimensions WxLxH (W-left/right, L-front/rear)	1600 x 800 x 1200 mm <i>height 1600 mm with exhaust ventilator or signal tower</i>		1600 x 1400 x 1200 mm <i>height 1600 mm with exhaust ventilator or signal tower</i>	
Machine weight (without liquid)	220 kg	250 kg	350 kg	450 kg
Maximum power input	5,3–9,4 kVA	10,2–10,6 kVA	10,2–10,6 kVA	10,2–10,6 kVA
Machine noise level	L _{Aeq} <70 dB			

Process data

Usable space (mm): WxLxH - W-left/right, L-front/rear, H-height	810 x 60 x 740 mm
Typical consumption of cleaning agent w/o load (per one cycle)	0.1 liter
Stencils capacity / dimensions	1 pc/584 - 813 mm (15"-32")
Stencils typical total cycle time	15 - 30 min
Stencils typical quantity per hour	2 - 4 pcs
Stencils typical consumption / cycle (cleaning agent)	0.15 - 0.2 liter
PCB defluxing and Misprints - max usable area at the disposal	0.50 m ²
Max load in 3U-160 eurocards (100x160mm) per one cycle	24 pcs
PCBA + Misprints 3U-160 eurocards (100x160mm) typical total cycle time	30 - 60 min
PCBA + Misprints 3U-160 eurocards (100x160mm) typical quantity per hour	24 - 48 pcs
PCBA + Misprints typical consumption / cycle (depends on PCB shape and pollution)	0.15 - 0.3 liter

* MINISWASH I
MINISWASH II

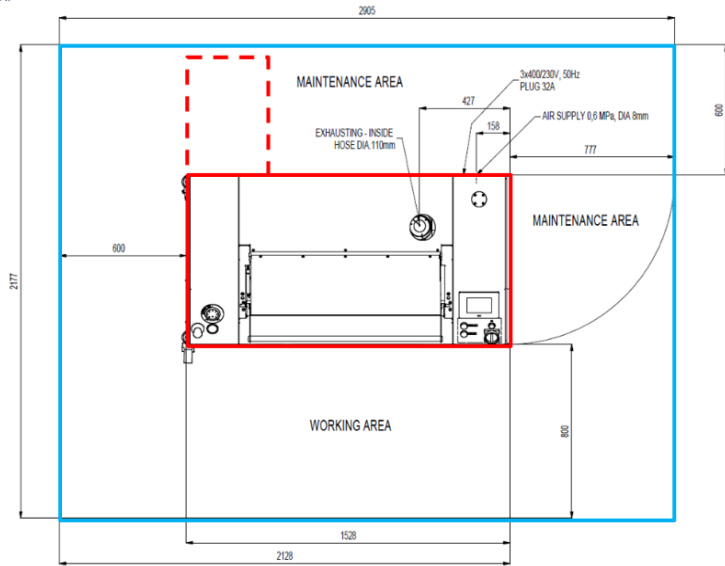

* MINISWASH III

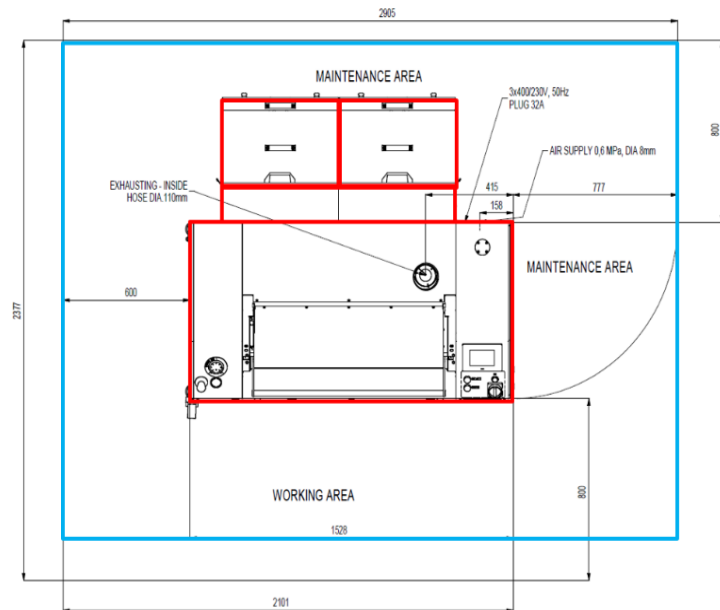

Necessary work space

From the front side of the machine – minimally 0.8 m area for machine operation
The machine rear part – min. 0.6 m area for machine maintenance and service (access to decanter, filtration unit)
From the right side – min. 0.8 m area for machine service – access space into the switchboard
From the left side – 0.6 m not necessary permanent access, machine can be drawn away on casters
Over the machine – 1 m space for door opening, inserting washed objects

Connection

Electric mains:	Power supply voltage: 3x 400/230V, 50–60Hz 3x 120/208V, 60Hz (option) Protection: 3x B 32 A Connection: 3, N + PE (five-wire plug 32 A)
Pressure air:	Pressure: 0.6–0.8 Mpa Connection: \varnothing 8 mm (SMC) Note: Pressure air consumption <1 l/min
Air exhaust:	Under-pressure 50–80 Pa (it corresponds to 5–8 mm of water column) Connection: OD 114 mm (machine top)
Water intake (II type – open loop):	Pressure: min. 0.2–5 bar Connection: G3/4" (outer thread)
Water outlet (II type – open loop) direct:	Connection: \varnothing 40 x 3,7 mm

*Top view:
Maintenance – Not necessary permanent access. Machine can be drawn away on casters

Dimensions

Machine height with the signal tower is about 345 mm higher, it is 1 540 mm.
 Machine height with the exhaust ventilator is about 365 mm higher, it is 1 560 mm.

MiniSWASH I

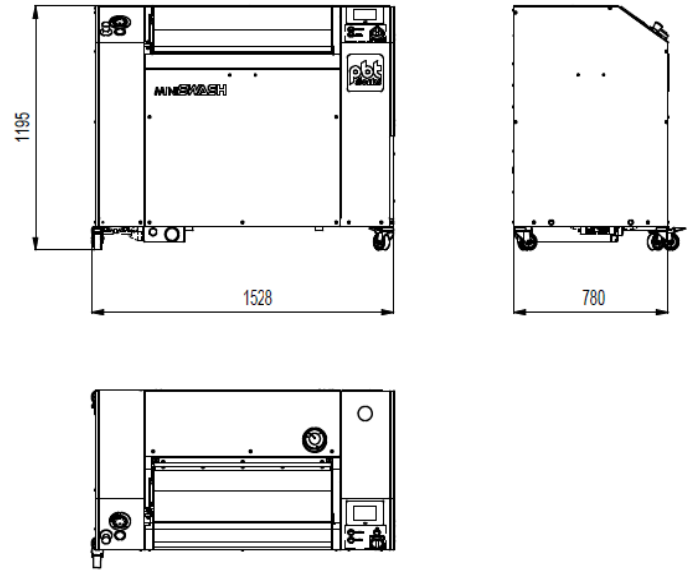

MiniSWASH II

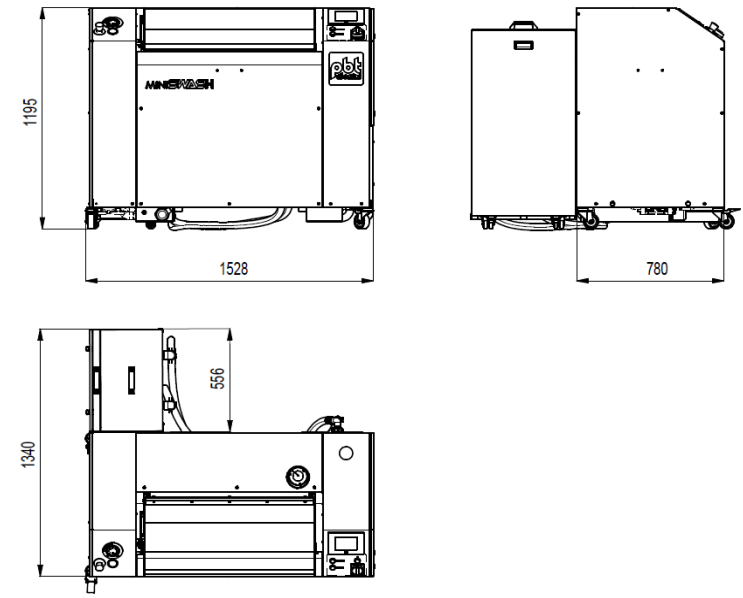

MiniSWASH III

